

Courses & Distances up
Susquehanna River

- N. 15 W 24
- N. 9 W 40
- N. 23 W 32
- N. 35 W 88
- N. 29 W 118
- N. 24 W 93.

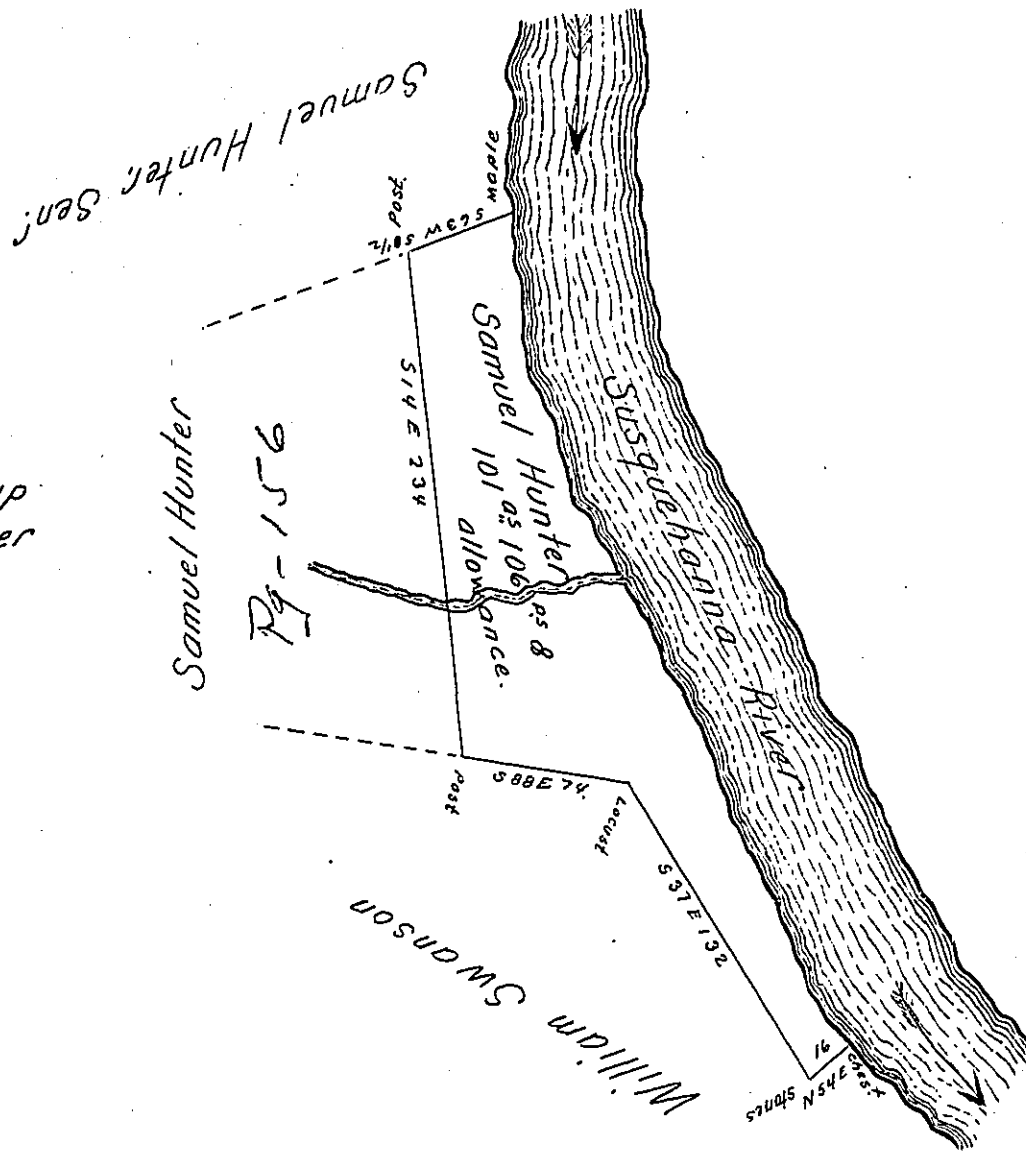

A Draft of a tract of land Situate in Rye Township Cumberland County containing one hundred one acres one hundred Six perches and Allowance. Survey'd 27th Jany 1819 in pursuance of an Order of Resurvey from the Honorable Board of Property dated the 12th Jany 1819. Warrent granted Samuel Hunter dated the 8th September 1755. by me in Virtue of a Special deputation

To Jacob Spangler, Esquire } Rob^t Clark D. S.
Surveyor Gen^l of Penn^a }

IN TESTIMONY that the above is a copy of the original remaining on file in the Department of Internal Affairs of Pennsylvania, made conformably to an Act of Assembly approved the 16th day of February, 1833, I have hereunto set my Hand and caused the Seal of said Department to be affixed at Harrisburg, this twenty fourth day of March 1905.

Isaac P. Brown
Secretary of Internal Affairs.